

QtPro™ Sound Masking Zone Wiring

- Open Office Area
- Control Module
- Conference Room
- Kitchen
- Private Office
- Lab

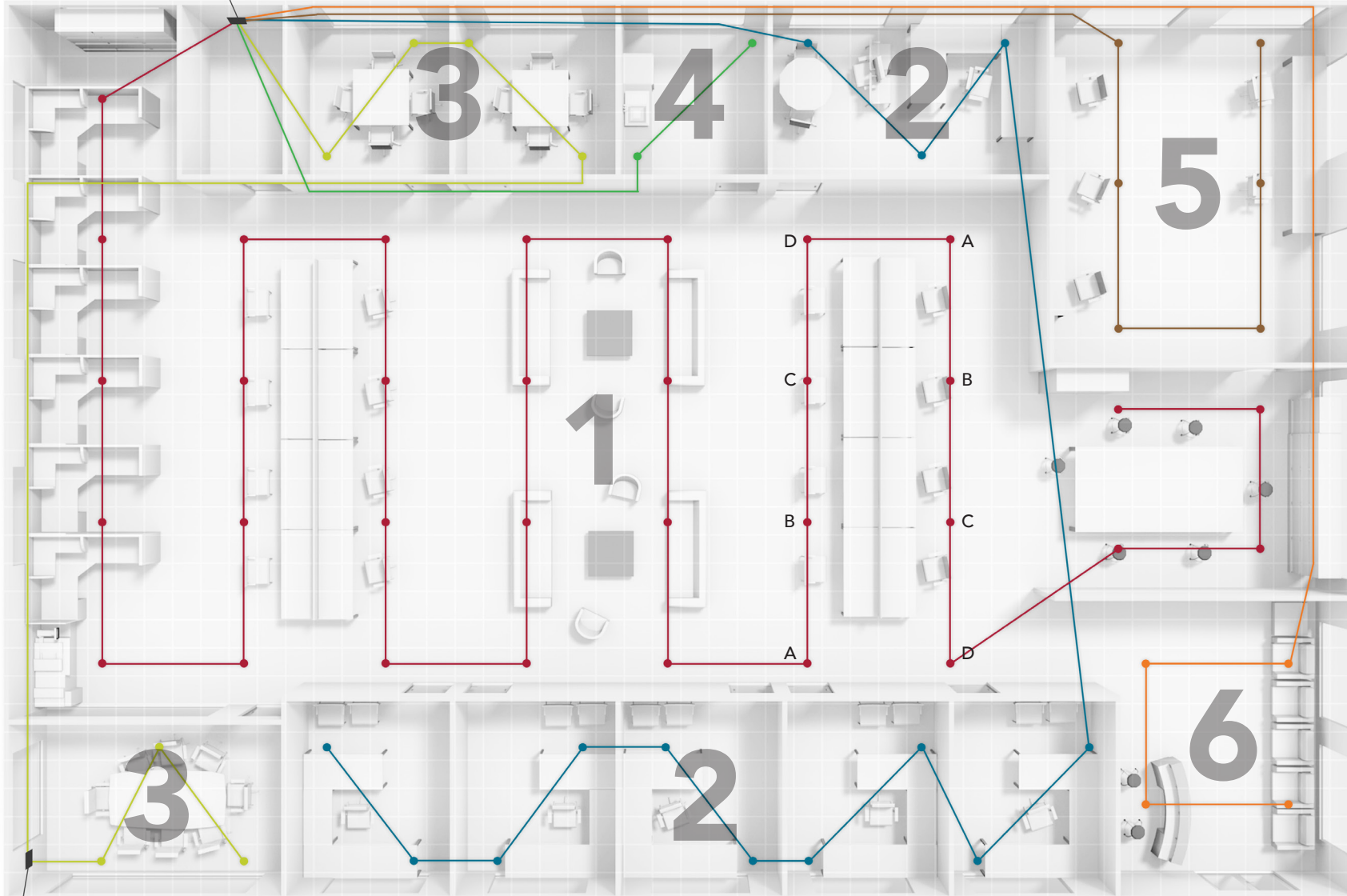

Space Specifications

- 5,294 ft² total
- 3327 ft² open office
- 10' ceiling height
- 6 zones – open and closed office space with music/paging

Equipment Used

- Qt™ 600 Control Module
- 65 Qt™ Emitters
- CAT-3 Cables and RJ-45 Connectors
- 1 Qt™ Room Control

Four Channel Distribution

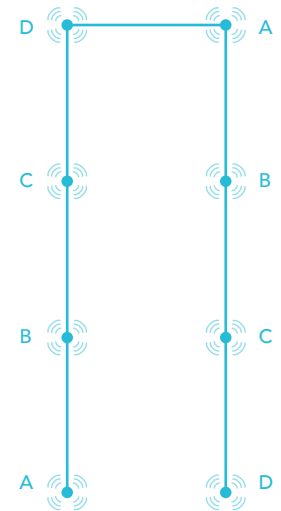

- Qt Room Control
- Conference Room
- Private Office
- Lobby - Music/Paging

QtPro™ System Layout Guidelines

1 Determine the number of zones

- The number of zones required is based on the acoustics of the space, not the size of the space.
- A single zone can range from 100 ft² (e.g. conference room) to 12,000 ft² (e.g. call center).
- Large open areas and small private areas require separate zones.
- Areas with different sound masking levels, or paging and music capability, require their own zone.
- An area with different ceiling heights or ceiling types may require multiple zones.

Tip: Cambridge Sound Management employs a team of layout designers, field engineers, and acousticians to help determine proper placement and zoning.

2 Calculate the number of emitters

Emitters are installed in a grid pattern determined by ceiling height.

Ceiling Height	Emitter Grid Spacing
Less than 8' 5"	8' by 8'
8' 6" to 11' 6"	10' by 10'
11' 7" and above	12' by 12'



Open Office Calculations

Use the formula below to calculate the number of emitters required.

Formula	Example
$\frac{\text{(Square footage)}}{\text{(Emitter grid spacing)}^2} \times 1.03 = \text{Emitters req'd}$	$\frac{3327}{10 \times 10} \times 1.03 = 35 \text{ Emitters req'd}$

Private Office Calculations

Office Size	Up to 180ft ²	180-260ft ²	260-340ft ²	340-420ft ²	420-500ft ²
Emitters	2	3	4	5	6

Approximate and for budgetary purposes only.

3 Select a QtPro control module



One zone
Up to 120 emitters
Covers 12,000ft²



Three zones
Up to 360 emitters
Covers 36,000ft²
Network Accessible



Six zones
Up to 720 emitters
Covers 72,000ft²
Network Accessible

Tip: Easily scale sound masking by adding multiple QtPro control modules.

4 Consider accessories



Qt™ Room Control

- Available for small spaces
- Volume control for up to 8 emitters

Popular Mounting Options

- Drywall Mount - Mounts emitter directly into the ceiling
- Universal Bracket- Mounts emitter to wall and ceiling materials and rotates in 45-degree increments



1



2

5 Follow installation best practices

- Each zone can support a maximum of 120 devices (using 2 runs of 60 emitters or Qt Room Control devices).
- Each run can support up to 1,000 feet of cable.
- Emitters should be installed no closer than 2 feet, and no more than 6 feet from structures.
- Emitters can be moved up to 2 feet in any direction.
- Emitters must be at least 8 feet and no more than 12 feet from surrounding emitters.
- Emitters are daisy-chained together using CAT-3 or better, high plenum-rated cables and RJ-45 connectors.
- Adjustable emitters can be changed -3, -6, or -9 dB to lower volume.